

Vibo FlyBox

Product Features



The Vibo FlyBox is a modern solution for 450mm/500mm and 600mm blind corner cabinets. This easily accessible unit allows four storage boxes to be pulled out from the cabinet with minimal effort and soft-close functionality provides a whisper quiet return to the cabinet interior. Thin, yet rigid sidewalls, a high load capacity and reversible installation make the FlyBox as rugged and reliable as it is beautiful and convenient.

- Two sizes available: 450mm/500mm (18" / 19 5/8") or 600mm (24")
- Full soft-close
- Two drawers per tier
- Snap together storage boxes streamline assembly
- Reversible for left or right side installation, simplifying the ordering process
- Load capacity: 25kg (55lbs) per tier

What's In the Box

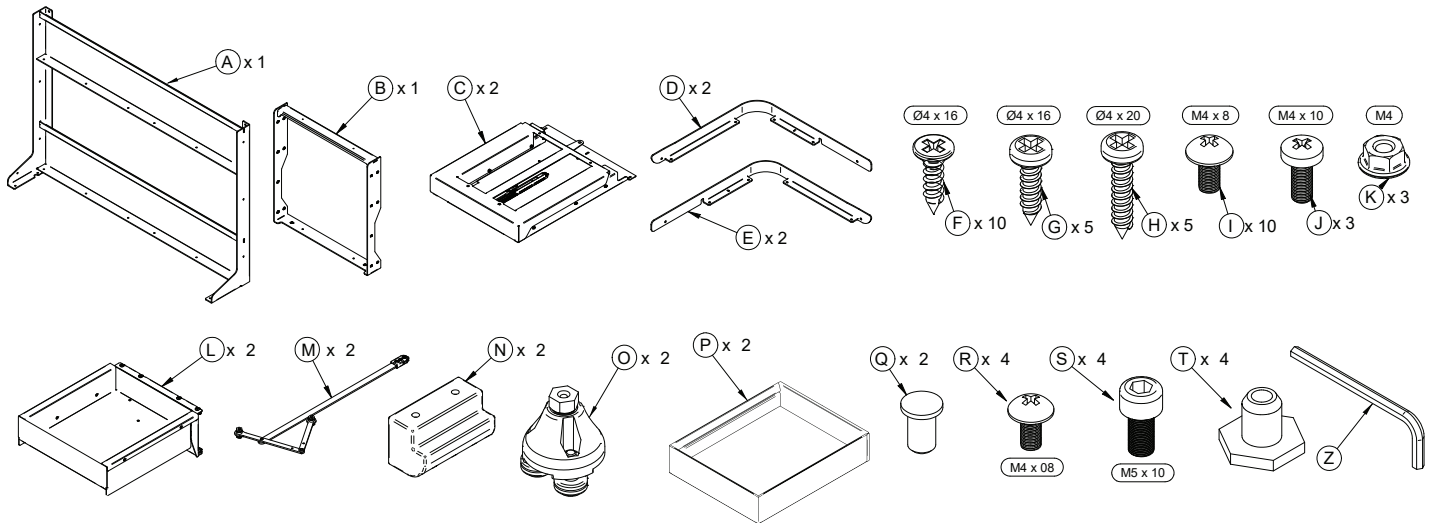

Ordering Guide

Size	Dimensions (W x D x H)	Part#
45/50cm (18"/19 5/8")	825mm x 489mm x 560mm (32 31/64" x 19 1/4" x 22 3/64")	041-VFLYBOX45-LAMINA-IS
60cm (24")	975mm x 489mm x 560mm (38 25/64" x 19 1/4" x 22 3/64")	041-VFLYBOX60-LAMINA-IS



Left Side Cabinet Installation Step #1

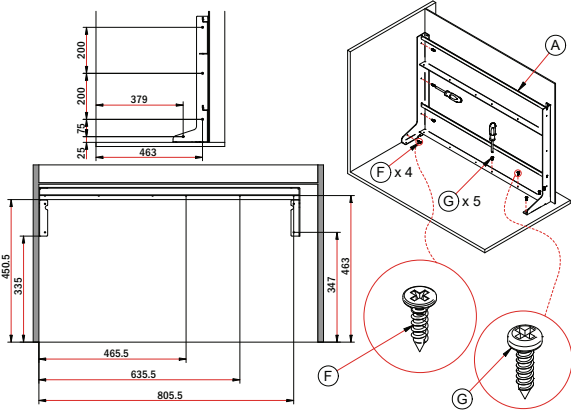

Step #2

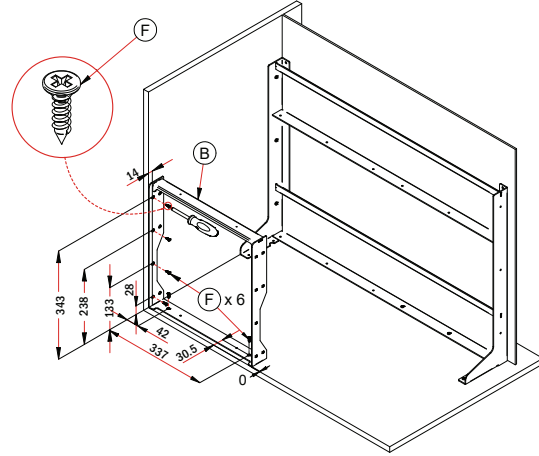

Step #3

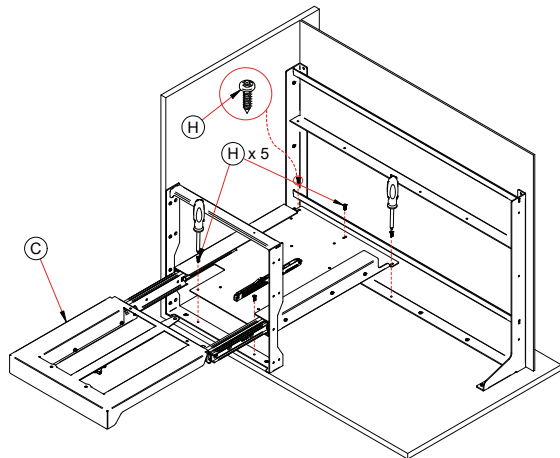

Step #4

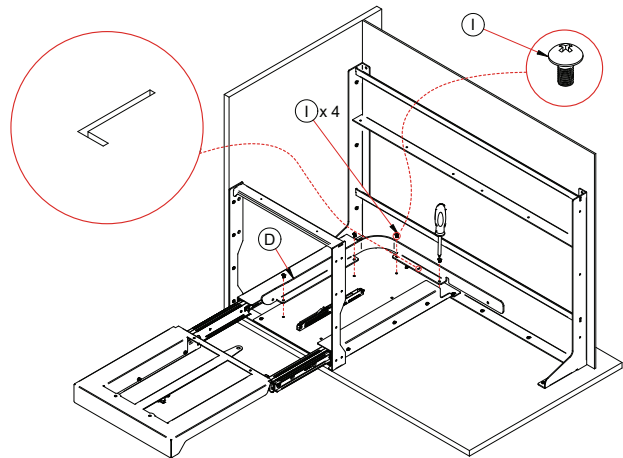

Step #5

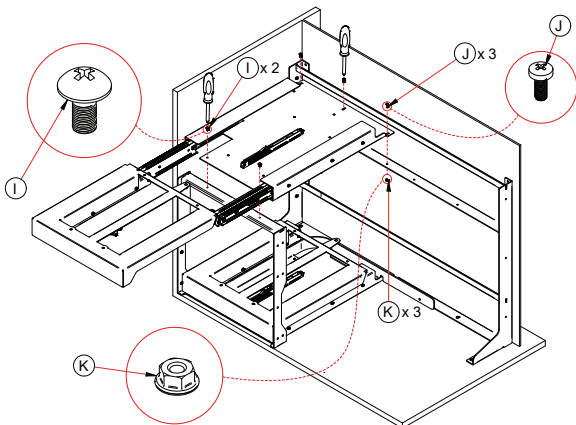

Step #6

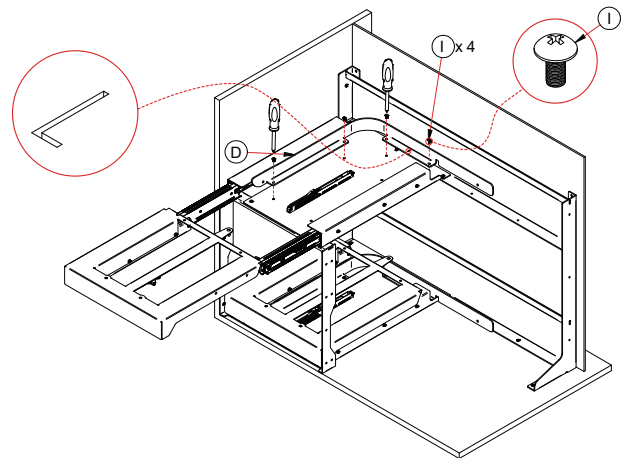

Right Side Cabinet Installation Step #1

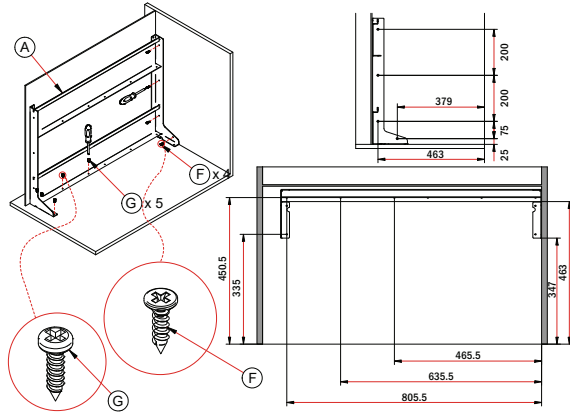

Step #2

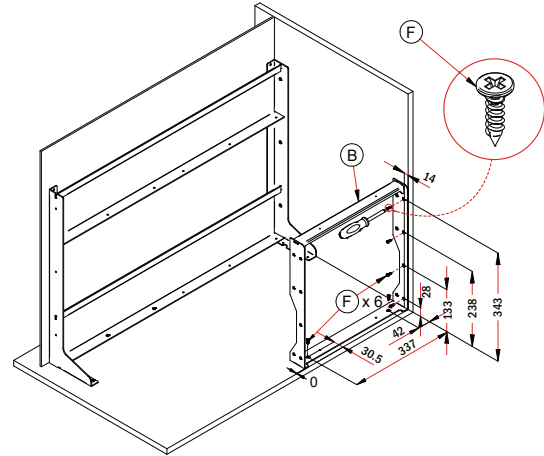

Step #3

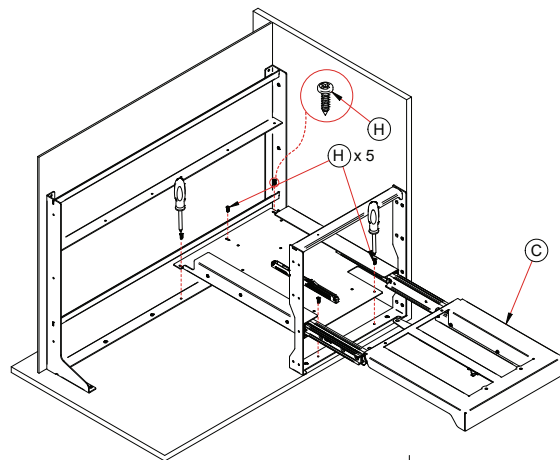

Step #4

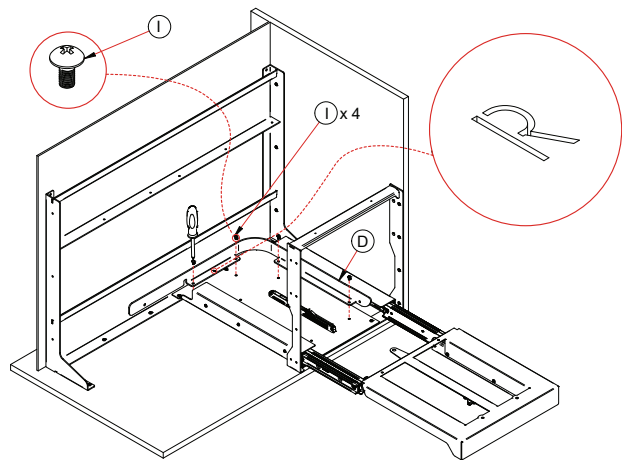

Step #5

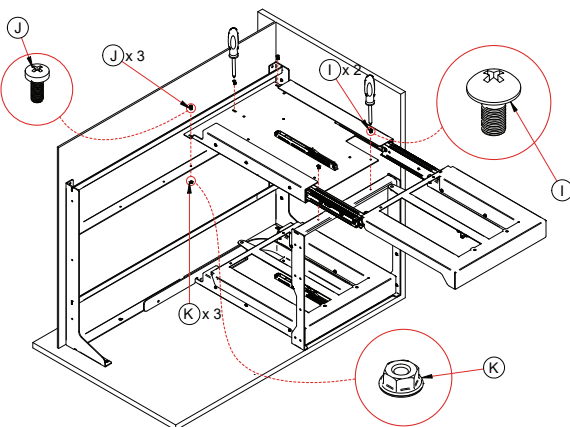

Step #6

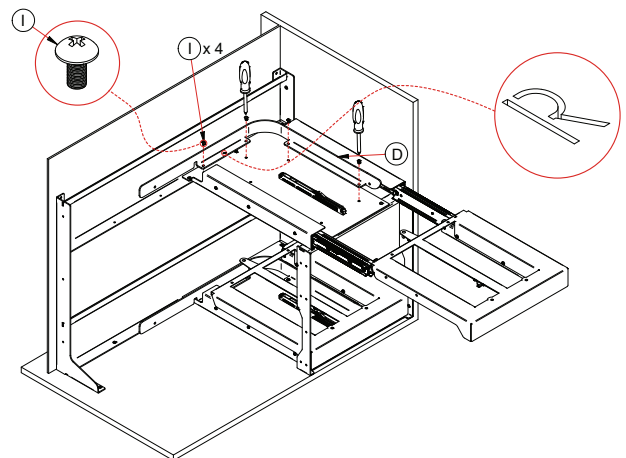



Left Side Storage Box Installation Step #1

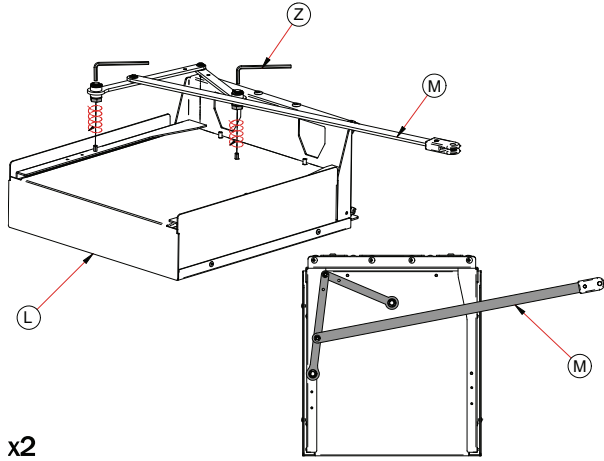

Step #2

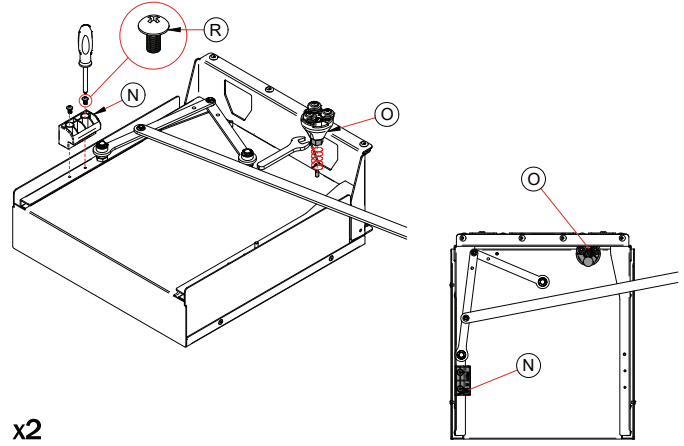

Step #3

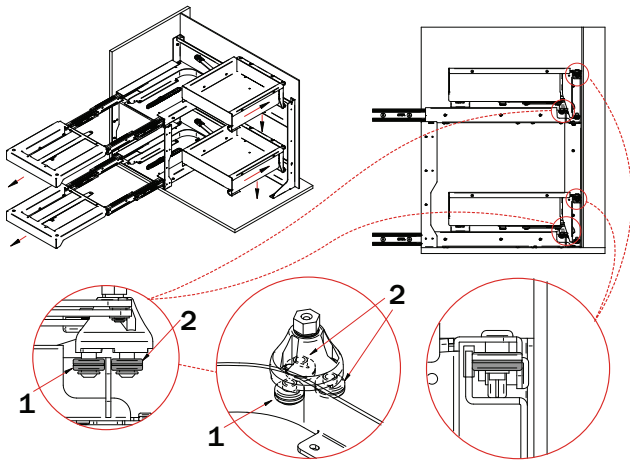

Step #4

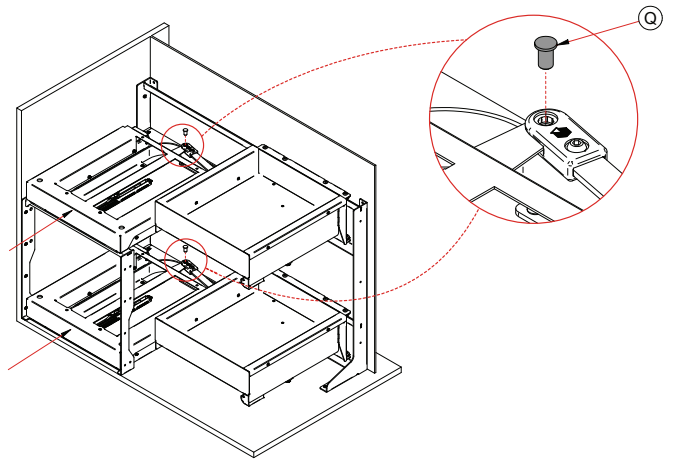

Step #5

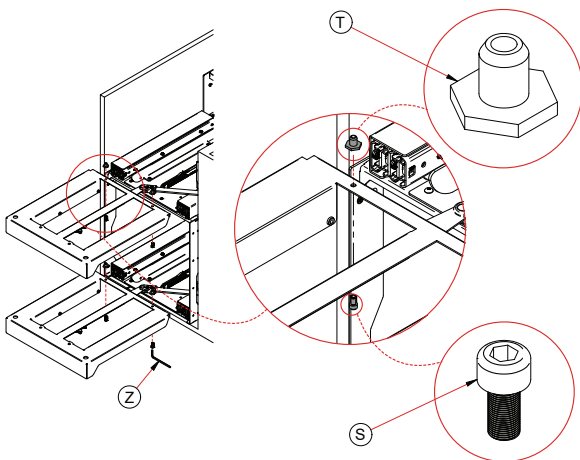

Step #6

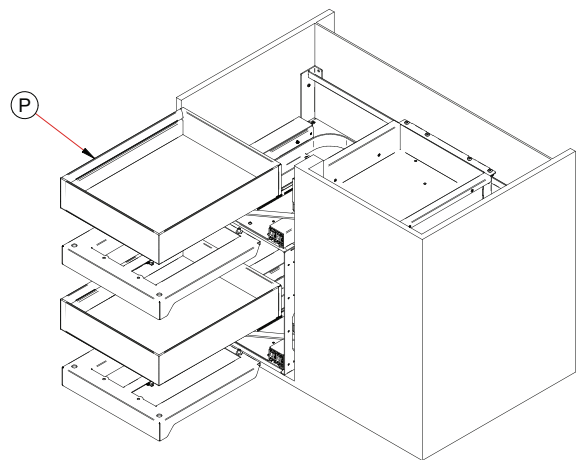

Right Side Storage Box Installation Step #1

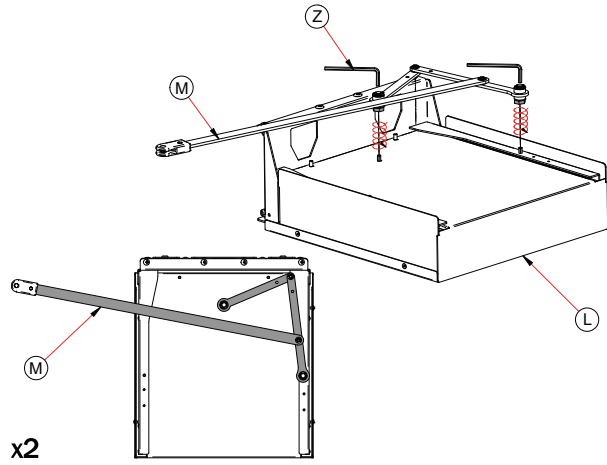

Step #2

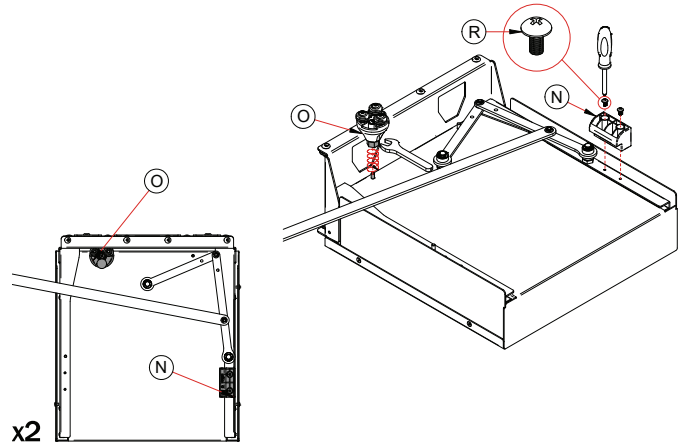

Step #3

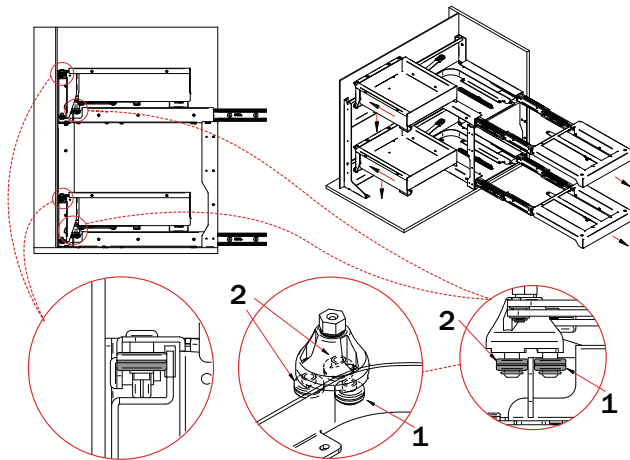

Step #4

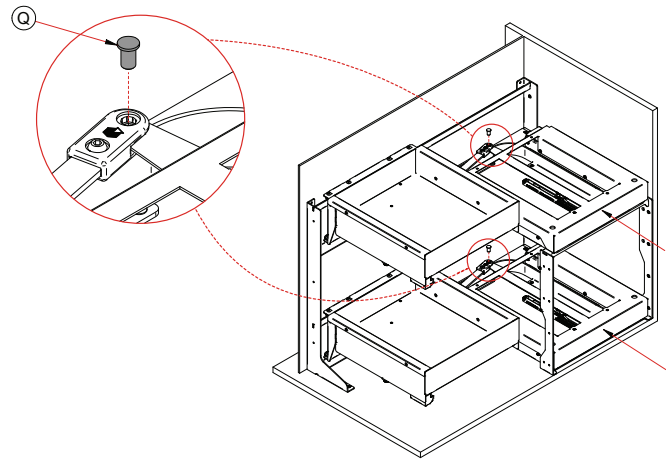

Step #5

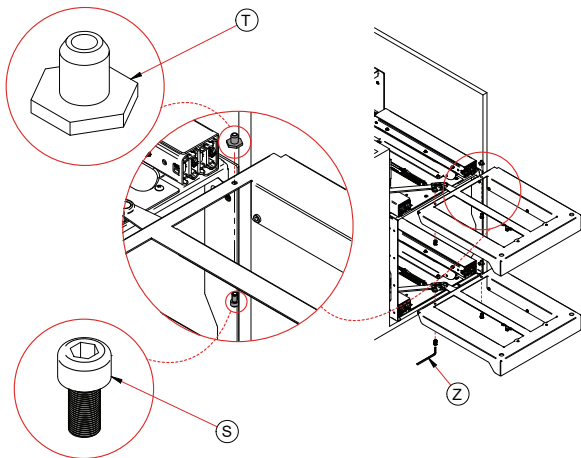

Step #6

