



## Double Wall System 500mm Grey

**Part Number: 105-MA500G**

Closing Type	Infinity Soft-Closing
Colour	Grey
Drawer Side Height	83 mm
Length	500
Load Capacity	40 kg
Slide Extension Type	Full Extension

### Product Description

The **Doublewall Drawer Systems by DTC** are engineered and manufactured to exact specification, thus ensuring a long and reliable product lifetime that will stand up to the rigours of demanding use. We are so confident that this is slide will meet or exceed your needs, that they carry a **limited lifetime warranty** on product failure and craftsmanship. In addition, they have been **certified by independent testing** and certification agencies to **exceed the highest of European and American standards** for slides.

As the exclusive distributor of DTC's products in Canada, we have the **Doublewall Drawer System** in a range of styles as needed for your application. Available in white, grey and stainless steel finishes. There are a number of optional items to provide boxesides, lateral rails or other accessories. All **Doublewall Drawer Systems** slides include as standard our Infinity Soft-Closing System for that effortless and silent close.

### Product Advantages

- Covered under Limited Lifetime Warranty
- Exceeds European/American standards
- Infinity Soft-Closing System
- Tool-less assembly/removal

### Included Products

Doublewall Drawer Kits include:

- One pair of full extension Infinity Soft-Closing slides
- One pair of doublewall drawer sides (83mm height)
- One pair of Infinity Soft-Closing Systems cover caps
- One pair of rear fixing brackets
- Two universal drawer front connectors

## DRAWER ADJUSTMENT INSTRUCTIONS



1. Remove cover cap on both sides of drawer.

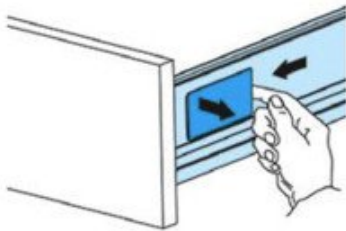

2. Turn the up/down or left/right adjustment screws. There is a maximum of  $\pm 2\text{mm}$  height and  $\pm 1.5\text{mm}$  lateral adjustment possible.

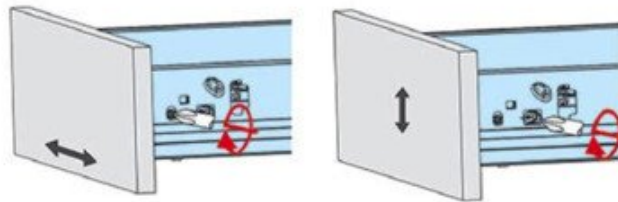

When finished with your adjustments, snap the cover caps back onto the drawer.

## DRAWER REMOVAL INSTRUCTIONS



1. Remove cover cap on both sides of drawer.

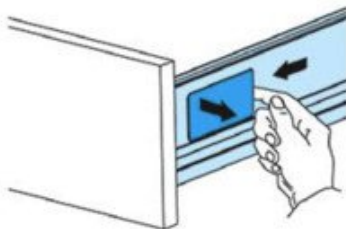

2. Use finger to release drawer on both sides and pull drawer forward to remove from slide.

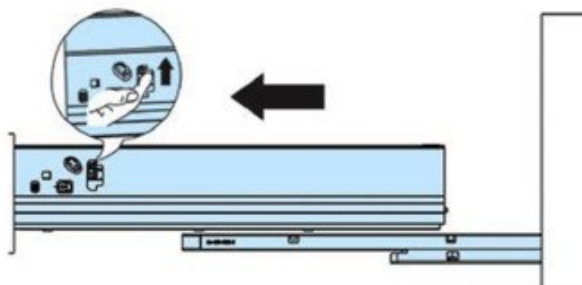

To re-install, place drawer on extended slides and push the drawer in fully. When it clicks, the lock will be engaged. Replace cover caps on both sides.