



## Bracket Set 4 PULL-IN Euro Screw Nickel

**Part Number: IFC010001926**

Pull-In Shelf Support Bracket (Set of 4)

The Pull-In Corner Bracket, crafted from high-quality zamak, ensures seamless, secure joints between panels with two euro screws and comes in nickel-plated finish.

Finish	Nickel
Load Capacity	100 kg
Material	Metal - Zinc Alloy

### Product Description

The Pull-In Corner Bracket, a key member of our shelf support family, is expertly engineered to provide a seamless and secure connection between panels. Its unique design allows for easy side-to-shelf or back-to-side pulls by simply fastening two Euro screws with flat countersunk heads, tailored to your specific application.

Crafted from premium zinc alloy, this bracket is available in a sleek Nickel Plate finish. It comes in a set of four brackets and eight euro-screws.

### Product Advantages

- Rounded lines smooth the visual of the “technical” bracket.
- Load capacity: 100 kg for 5mm pins.
- Integrated pull-in design , less effort to assemble shelf in a permanent position in the cabinet and add structural support to the shelving unit.
- Packaging: Bag with a set of four (4) Pull-in Brackets and eight (8) Euro-screws.



## Technical Documents

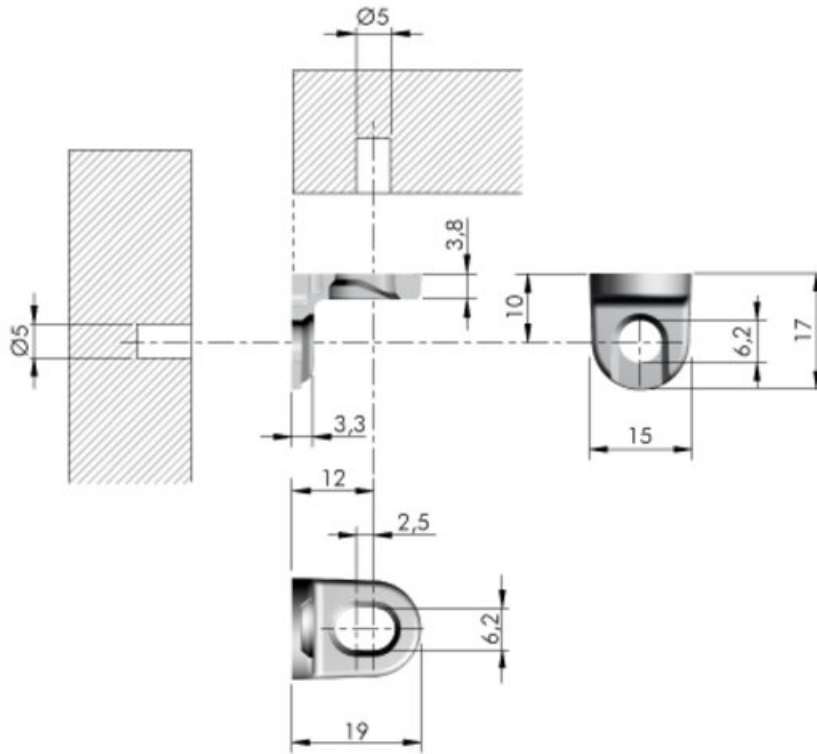

View this product online at <https://marathonhardware.com/pd/IFC010001926>

Technical Documents



View this product online at <https://marathonhardware.com/pd/IFC010001926>

