



Kemsley Pull 320mm Brushed Satin Nickel

Part Number: 9560-320-BSN



Kemsley Classic Pull, 320mm, Brushed Satin Nickel

The Kemsley's wide body and seamlessly molded feet showcase its clean lines.

Center to Center Length	320 mm
Collection	Kemsley
Colour Group	Silver
Finish Code	Brushed Satin Nickel
Material	Zinc Diecast
Overall Length	389 mm
Projection (Height)	30 mm
Style Family	Classic
Width	15 mm

Product Description

The *Classic* lineup consists of a variety of best-selling, traditional designs. Quickly update your current kitchen with a complementary style in one of our on-trend finishes or add a rustic touch to your newly redesigned space.

Our complete Decorative Hardware lineup is globally sourced, using some of the best materials available in the industry. We strive to offer in the latest on-trend finishes and exclusive, awe-inspiring European designs, in our high-quality decorative hardware. And it's all backed by our Limited Lifetime Warranty.

Included Products

Industry standard mounting hardware



Technical Documents

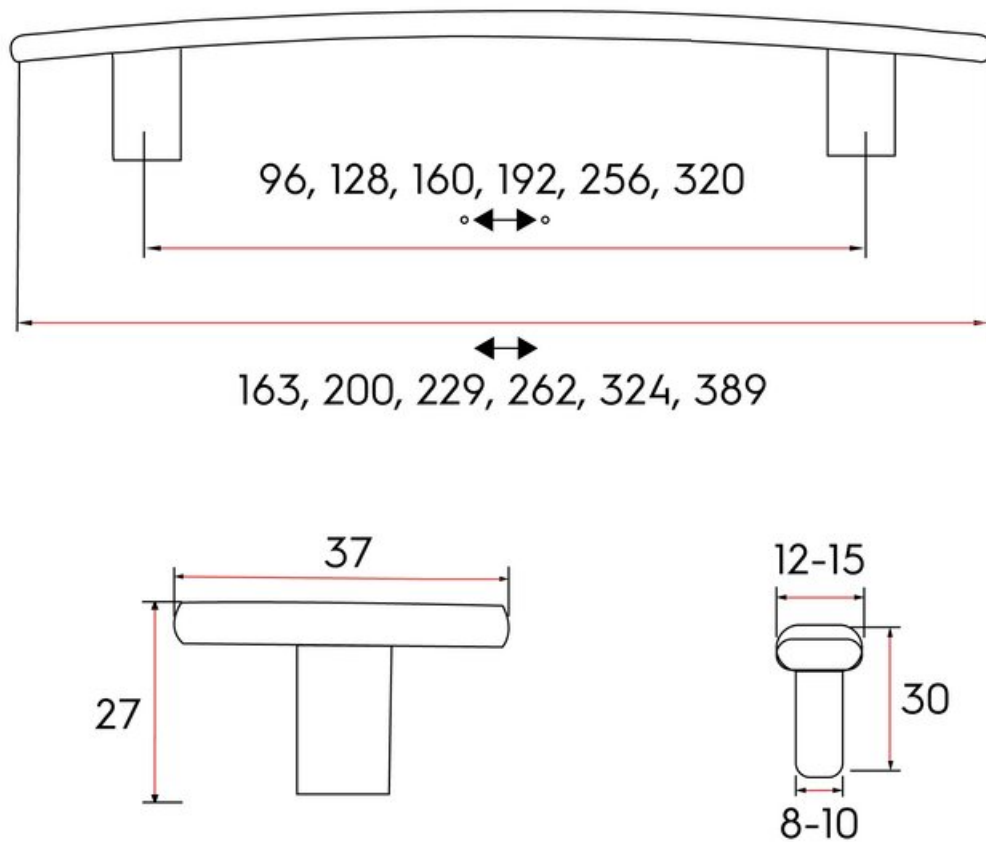

View this product online at <https://marathonhardware.com/pd/9560-320-BSN>

