

## Curve Pull 416mm Brushed Stainless Steel



**Part Number: V0117416L24**

Curve Edge Pull, 416mm, Brushed Stainless Steel

This lightweight, yet durable contemporary finger pull suits a wide range cabinet doors and drawer fronts.

Center to Center Length	416 mm
Collection	Curve
Colour Group	Silver
Finish Code	Brushed Stainless Steel
Mounting Type	Wood Screws (included)
Overall Length	500 mm
Projection (Height)	36 mm
Style Family	Designer
Type	Finger Pull

### Product Description

As the years go by, the Curve handle continues to be a success due to its lightness, the fact it is easily installed and its design. It is fitted to the upper part of cupboards and drawers and it takes up such a small space that it functions perfectly in any type of kitchen. Its curved profile of 1mm covers most of the width of the upper part of the furniture, looking as if it discretely pops out of the furniture itself. The stainless steel finish – the king of the range – is available in six overall lengths of 45, 100, 200, 300, 400 and 500mm. A great variety that allows for the creation of different combinations in all types of surroundings.

### Included Products

Industry standard mounting hardware



## Technical Documents

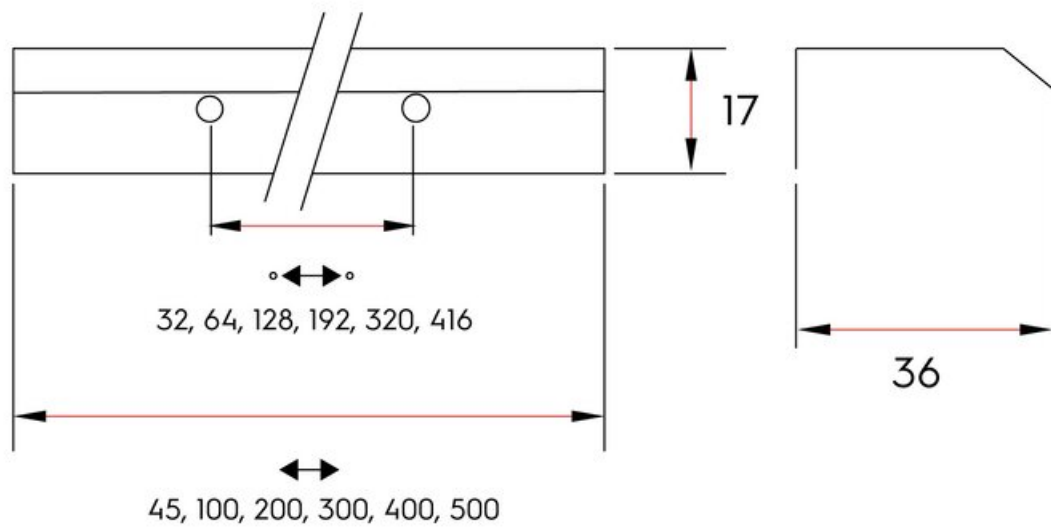

View this product online at <https://marathonhardware.com/pd/V0117416L24>

