



St. Vincent 6-5/16 in (160 mm) Center Cabinet Pull - Polished Nickel

Part Number: A36645PN

St. Vincent Pull, 6-5/16 in (160 mm), Polished Nickel

The St. Vincent Collection is the perfect balance of angular lines, metallic faceted edges and soft curves. St. Vincent's geometric shape naturally catches light for a dramatic effect.

<div>
</div>

Center to Center Length	160 mm
Collection	St Vincent
Colour Group	Silver
Finish Code	Polished Nickel
Material	Zinc Diecast
Overall Length	222 mm
Projection (Height)	37 mm
Style Family	Designer
Type	Pull
Width	16 mm

Product Description

The Amerock A36645PN St. Vincent 6-5/16 in. (160mm) Center Cabinet Pull is finished in Polished Nickel. The St. Vincent Collection is the perfect balance of angular lines, metallic faceted edges and soft curves. St. Vincent

Product Advantages

- Gorgeous, high-end finishes available
- Intricately crafted with precise detail for lifelong beauty and durability
- Amerock Guardian Lifetime Guarantee against defect in material and workmanship

Included Products

Industry standard mounting hardware



Technical Documents

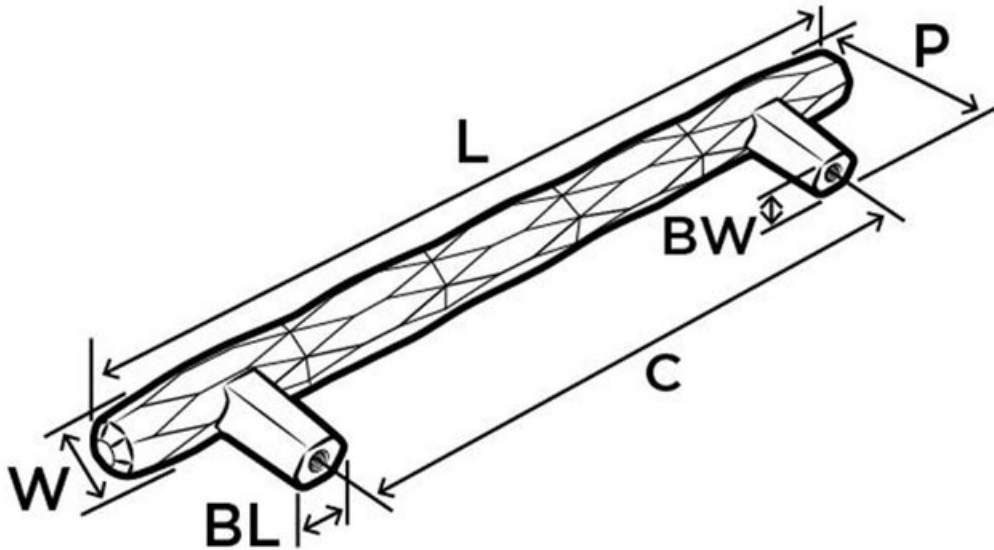

L (Length) = 8-3/4in(222mm)

W (Width) = 5/8in(16mm)

P (Projection) = 1-7/16in(37mm)

C (Center-to-Center) = 6-5/16in(160mm)

BL (Base Length) = 1/2in(13mm)

BW (Base Width) = 3/8in(10mm)

Profile# 36645

View this product online at <https://marathonhardware.com/pd/A36645PN>



Technical Documents

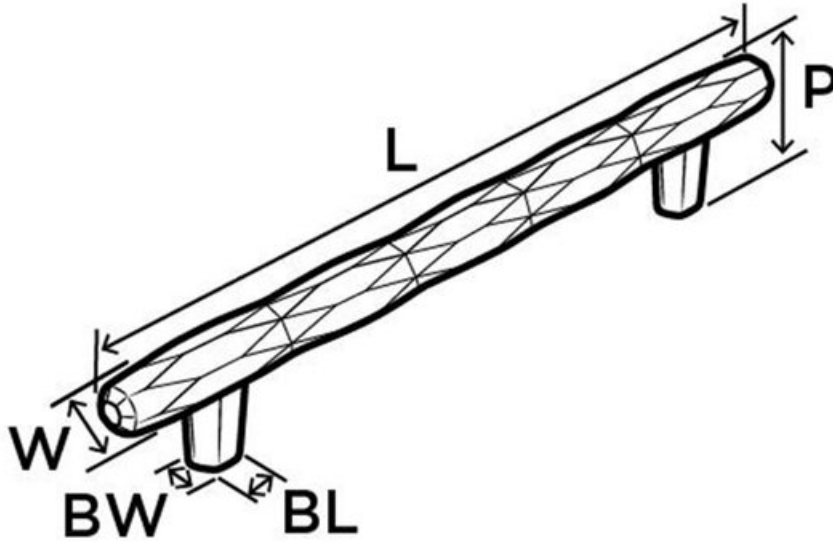

L (Length) = 8-3/4in(222mm)

W (Width) = 5/8in(16mm)

P (Projection) = 1-7/16in(37mm)

BL (Base Length) = 1/2in(13mm)

BW (Base Width) = 3/8in(10mm)

Profile# 36645

View this product online at <https://marathonhardware.com/pd/A36645PN>



Technical Documents



INSTALLING NEW CABINET HARDWARE

Step 1. Location of Cabinet Hardware

While there are no hard, fast rules for placement of a knob or pull on a cabinet door, most cabinet makers will locate them approximately 3"-4" above the upper non-hinged corner on base cabinets, or the lower non-hinged corner on wall cabinets. However, the decision is your to make!

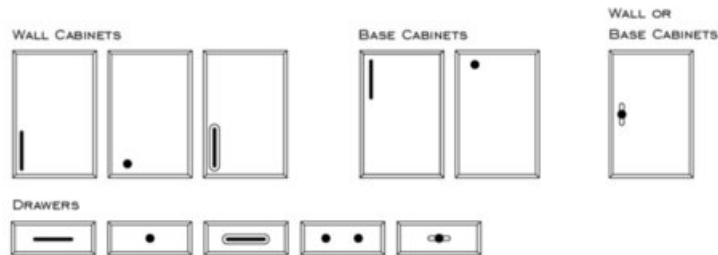

Step 2. Mounting Cabinet Hardware

When drilling for a knob or pull, a 3/16" hole is recommended for most styles. The exception is pulls that have "studs". A stud is simply an extension of the molded screw holes. If a pull has a stud, then a 1/4" hole is required with studs sitting securely in the wood.



IMPORTANT Screw Information

Amerock® includes 8-32 x 1" long machine screws with most knobs and pulls because the typical cabinet door or drawer front is 3/4" thick. This screw length should work in most applications. However, if your cabinet doors or drawer fronts are thicker than 3/4", then you will need to use longer screws for mounting. Check the thickness of both a cabinet door and a drawer front in your kitchen, as the thickness dimensions may not be the same. In general, the screw length(s) used should be 1/4" longer than the thickness of your cabinet door or drawer front material. It is not uncommon for some drawers to be constructed with a 3/4" thick front attached to a 3/4" thick drawer box. In this situation, the total drawer thickness is 1-1/2", making a 1-3/4" long screw necessary for mounting. These screws may be purchased from any hardware store. Please note that select hardware sold by Amerock may include metric screws instead of UNC screws.

View this product online at <https://marathonhardware.com/pd/A36645PN>

