

Graf Mini Pull 256mm Brushed Black

Part Number: V0430256L30



Graf Mini Pull, 256mm, Brushed Black

Graf Mini (formerly Graf 2) is an extension of the successful Graf design, offering the on-trend knurled texture finish on any length.

Center to Center Length	256 mm
Colour Group	Black
Finish Code	Brushed Black
Mounting Type	M4 Machine Screw
Overall Length	278 mm
Projection (Height)	33 mm

Product Description

Graf Mini (formerly Graf 2) is a collection of knobs and handles with a texture and feeling that is unique in application. Its hammered steel surface ensures a perfect textured hold as it is pulled. Available in a range of finishes, styles and lengths.

The long handle [passed a traction strength test](#), as it resisted 14 kg (30 lbs) over 1 hour without deformation. This proves its suitability as an appliance pull.



Technical Documents

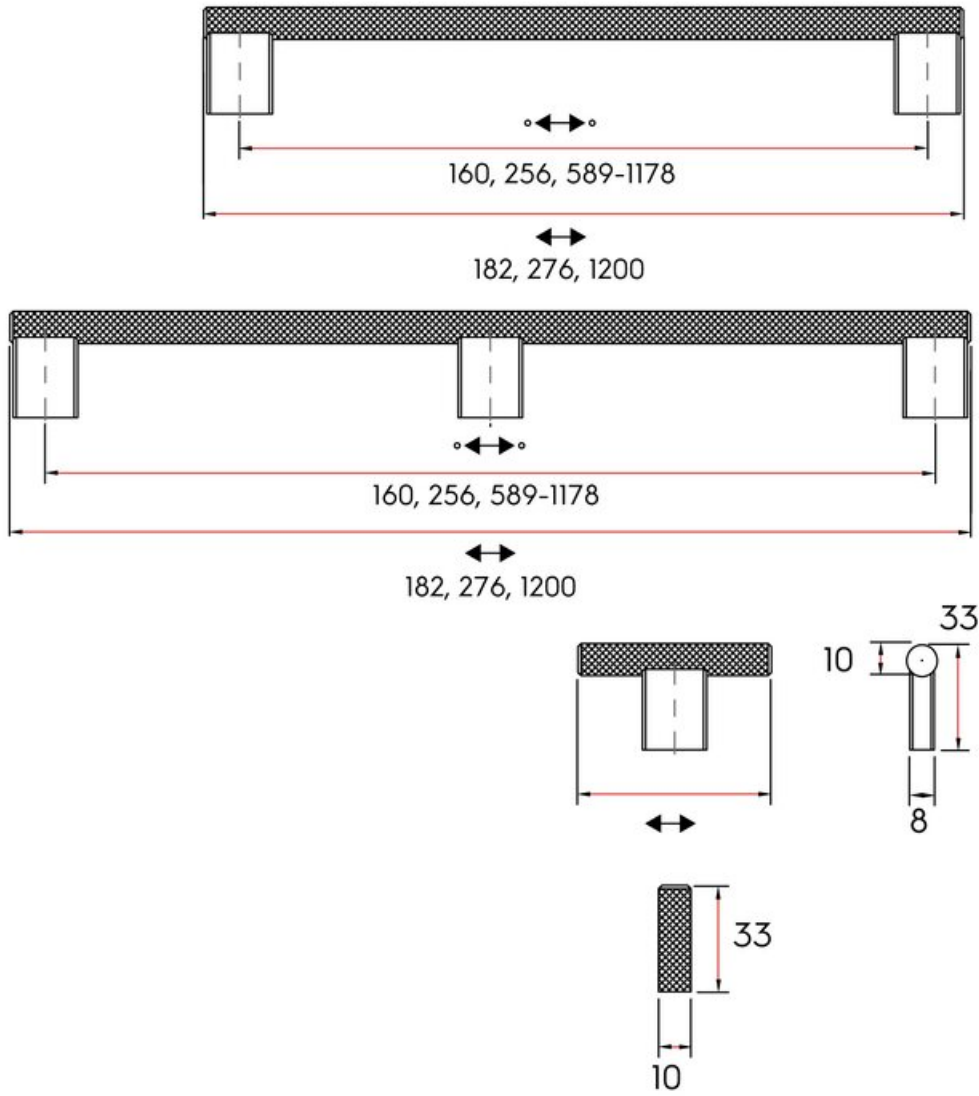

View this product online at <https://marathonhardware.com/pd/V0430256L30>



Technical Documents



NEW!

**0430
GRAF2**

ALUMINIUM

ALUMINIO

Designer: Metelli

Finishes / Anodiado

Standard silver tone

Black

Brushed dark brass

Brushed copper

Brushed black

Polished

Polished chrome

Polished nickel

Polished stainless steel

Polished titanium

Polished zinc

Polished zinc-plated

Polished zinc-plated with chrome

Polished zinc-plated with nickel

Polished zinc-plated with silver

Polished zinc-plated with gold

Polished zinc-plated with black

Polished zinc-plated with blue

Polished zinc-plated with red

Polished zinc-plated with green

Polished zinc-plated with purple

Polished zinc-plated with pink

Polished zinc-plated with white

Polished zinc-plated with black

Polished zinc-plated with silver

Polished zinc-plated with gold

View this product online at <https://marathonhardware.com/pd/V0430256L30>



Technical Documents

TECHNICAL PRODUCT SHEET

Viefe^{handles}

04301178LXX

Description:
Frontal handle screwed on the back of the door

Display:
Individual pack
Screw for assembly M4 x 25_3pcs

Material:
Aluminum

Finish:
Stainless steel look, brushed dark brass and
Brushed matt black.



Size:

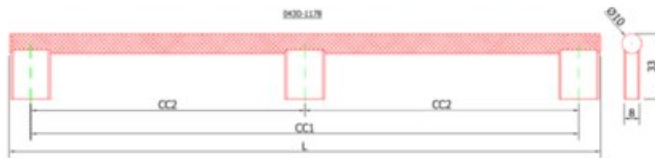

Model	L	CC1	CC2	H
0430-1178	1200	1178	589	33

Mechanical strength:
Traction strength test, the handles resist 14 Kg during 1h without deformation.

Cleaning:
Wet cloth
Use neutral cleaning products

Assembly drawing:
Not apply



View this product online at <https://marathonhardware.com/pd/V0430256L30>

