



## Feet FONDA 100mm Polished Chrome

**Part Number: V6005100L01**

Fonda Legs by Viefe (6005)

Center to Center Length	32 and 44 mm
Colour Group	Silver
Depth	80 mm
Design	Viefe® Team
Finish Code	Polished Chrome
Material	Aluminium
Projection (Height)	100 mm
Type	Furniture Legs
Width	60 mm

### Product Description

Furniture feet manufactured in aluminum. Especially suitable for furniture models that require adjustable legs to position itself correctly on the floor. It has a U-shaped groove incorporating an adjuster which can be manoeuvred so fixing the setting of the foot. Available in three sizes, Fonda includes four different finishes: polished chrome, stainless steel look, brushed black and the new brushed dark brass.



## Technical Documents

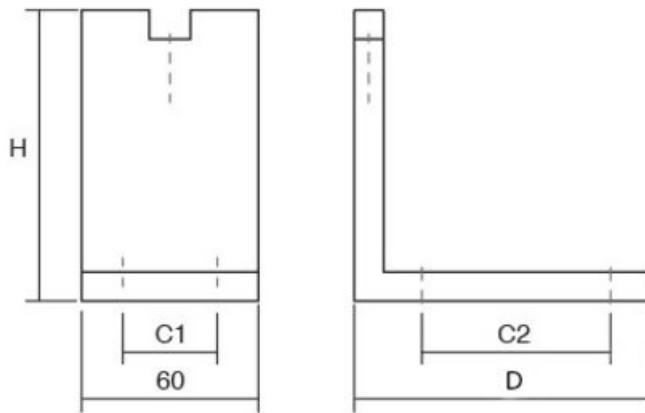

View this product online at <https://marathonhardware.com/pd/V6005100L01>



## Technical Documents



View this product online at <https://marathonhardware.com/pd/V6005100L01>

