



## Laundry Hamper 450mm 1x35L White

**Part Number: 04-LHF450-35-W**

M-Series Flip Down Laundry Hamper, 35L, 450mm, White

The Flip Down Hamper is the best option for small spaces with its narrow depth requirement. Best suited for 18" (450mm) wide cabinets.

Depth	261 mm (10-1/4 in)
Height	552 mm (21-3/4 in)
Load Capacity	10 kg (22 lbs)
Suggested for Cabinet (Door) Width	450 mm (17-3/4 in)
Volume	35L
Width	400 mm (15-3/4 in)

### Product Description

M-Series flip down / tilt out laundry hampers are a convenient laundry storage solution for shallow base cabinets in laundry rooms and closets. This single bin application offers homeowners the choice of a 35L or 48L storage bin with breathable design and integrated handles. The easy-to-remove bin design makes this laundry storage solution perfect for reducing the hassle often associated with laundry day.

### Product Advantages

- Tailored for slab or shaker style doors with a nominal size of 18"
- Minimal depth for shallow base cabinets in laundry rooms and closets
- Easily removable baskets with breathable design and integrated handles
- Two size baskets: 35L or 48L
- Full size positioning template included
- Load capacity: 10 kg (22 lbs)



## Technical Documents



### INTRODUCING NEW! Tilt-Out Laundry Hampers

Our new tilt-out laundry hamper offers a narrow depth option for convenient laundry storage. Featuring large storage bins with breathable designs and integrated handles, these are perfectly suited for installation in bedroom closets or bathroom linen areas.

The tilt-out laundry hamper includes a soft-close damper and installs with two of your own standard door hinges at the bottom of the door. Two versions are in stock with large 35L or 48L bins, for cabinets of 18" or 450mm outside width. Full height doors in both slab and shaker style are compatible.

### Product Features

- Door mount compatible for both slab and shaker doors
- Designed for full-height cabinet doors, not suitable for drawers above
- Installs with your standard cabinet hinge on bottom of cabinet/door
- Hinge offers door adjustment (depending on model)
- Tilt out arm included along with soft-close damper
- Removable baskets with breathable design and integrated handles
- Suits 18" or 450mm outside width cabinets
- Narrow depth suits closets (less than 11 or 14" depth required)
- Load Capacity: 10 kg (22 lbs)

View this product online at <https://marathonhardware.com/pd/04-LHF450-35-W>

## Technical Documents

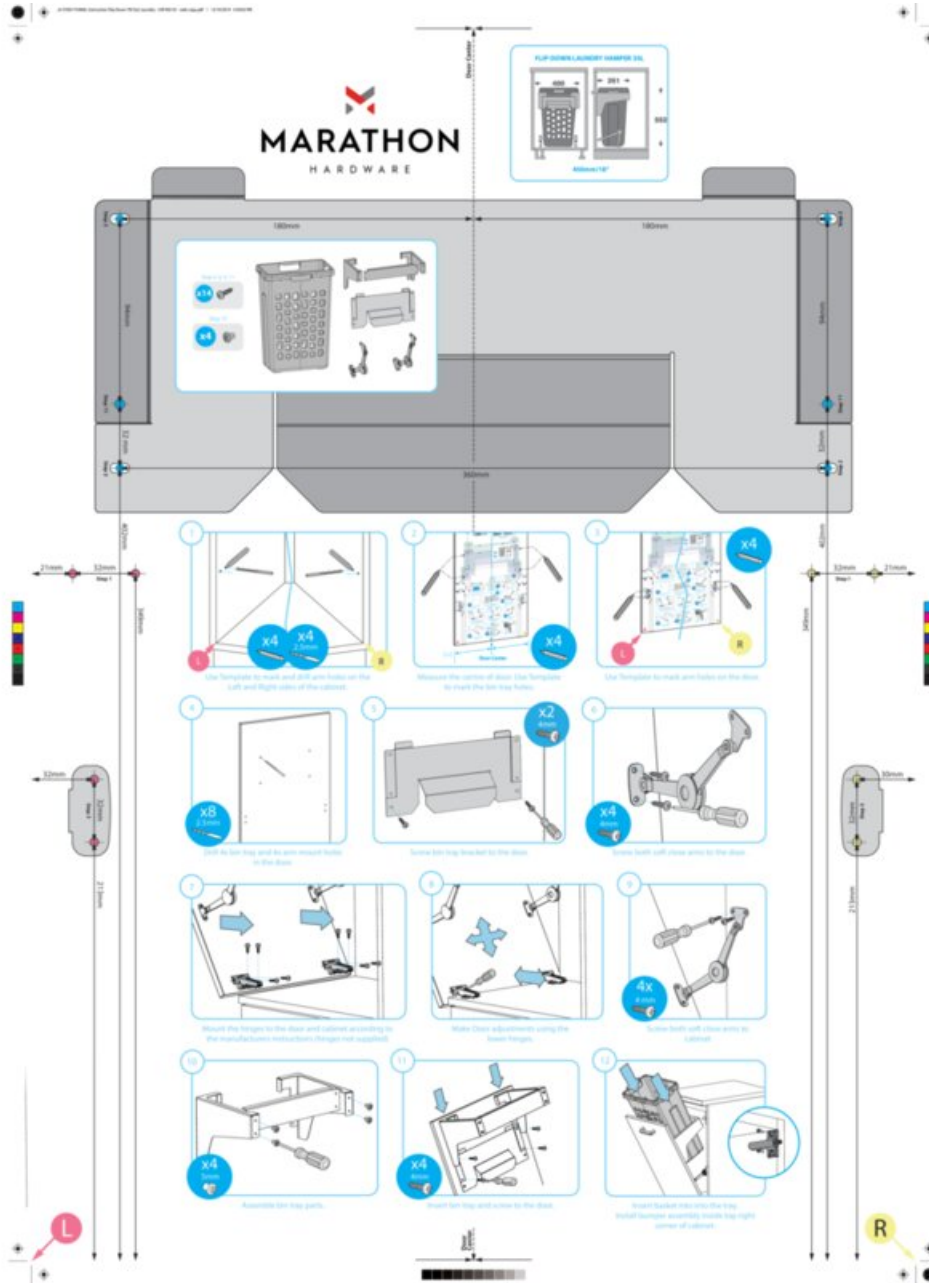

View this product online at <https://marathonhardware.com/pd/04-LHF450-35-W>

