

### M-Series Syphon Flex



### Product Features

The M-Series Syphon Flex is an excellent way to maximize storage with a functional top drawer below the sink in bathroom vanities, all while lowering production costs. The flexible plastic plumbing cutout is an ideal alternative to the arduous process of creating a custom cutout using wood or melamine.

- Highly flexible plastic makes bending to shape easy
- The cut-to-size design allows custom tailoring to most projects
- Easy to install
- Widely compatible with many sinks/fixtures
- Available in three modern colours: White, Anthracite, Graphite

### What's In the Box

- M-Series Syphon Flex

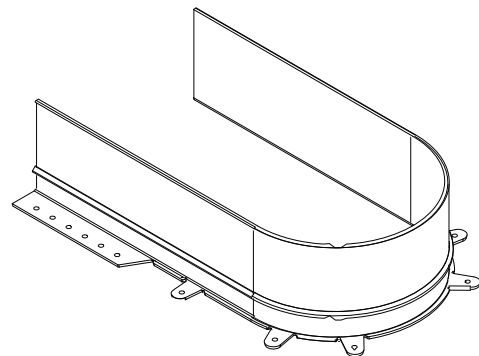

### Ordering Guide

Part#	Finish	Quantity/Box
04-1660-WH	White	40
04-1660-GR	Anthracite	40
04-1660-GP	Graphite	40

### Installation Dimensions

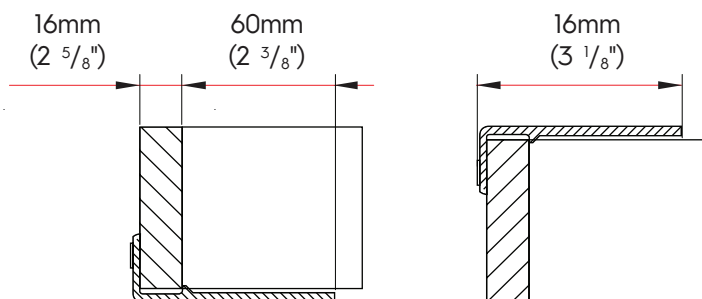
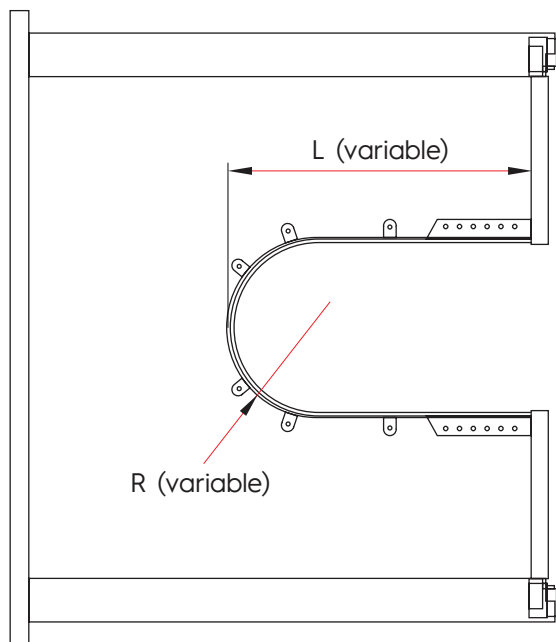

### Installation With End Caps - Step #1

### Step #2

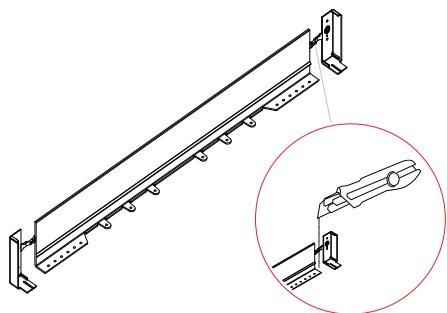

Cut off end caps

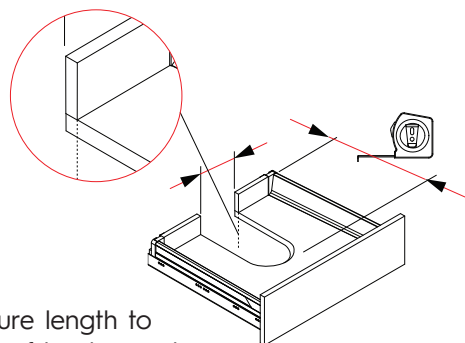

Measure length to  
inside of back panel

### Step #3

### Step #4

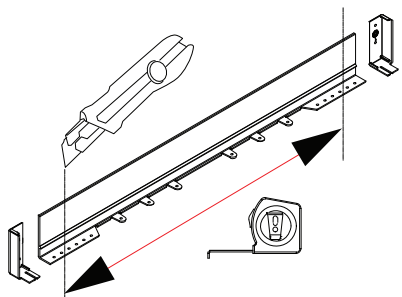

Cut to length

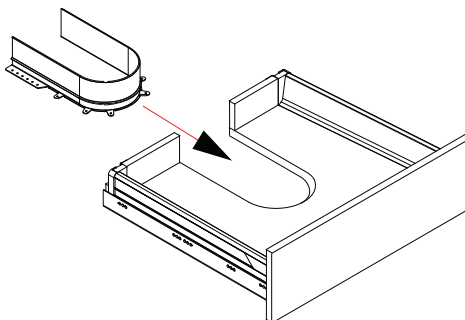

Slide into cutout



# MARATHON



## SERIES SYPHON FLEX

Technical Specifications & Assembly

### Step #5

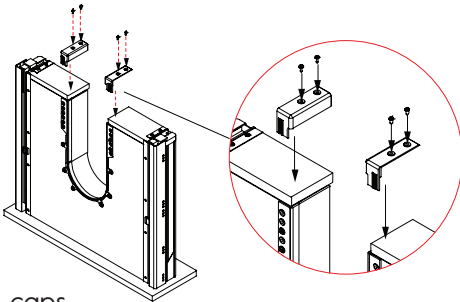

Affix end caps

### Step #6

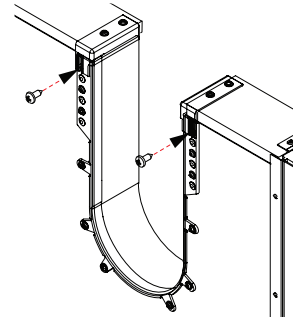

Secure to bottom

### Installation Without End Caps - Step #1

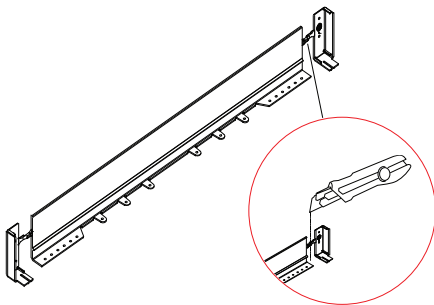

Cut off end caps

### Step #2

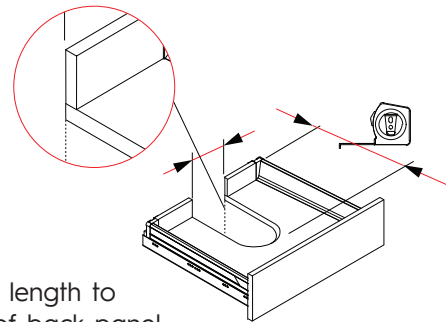

Measure length to  
outside of back panel

### Step #3

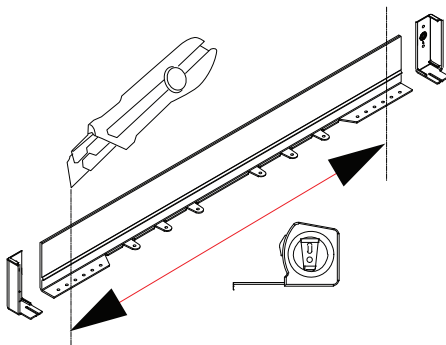

Cut to length

### Step #4

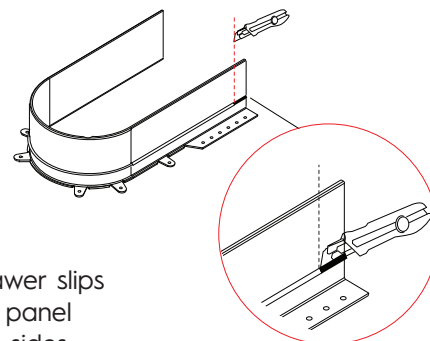

Trim drawer slips  
to back panel  
on both sides

### Step #5

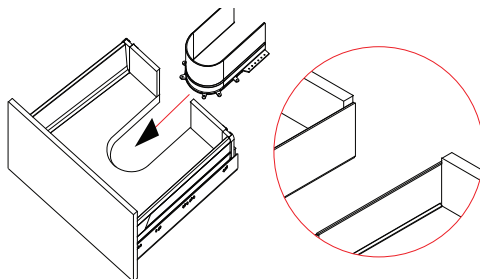

Slide into cutout

### Step #6

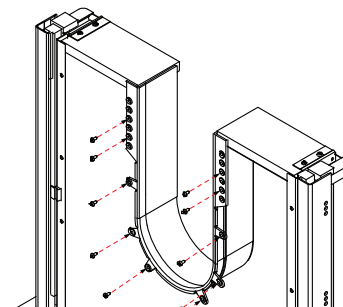

Secure  
to bottom